

ENCODER CONNECTOR TYPE AMP SUPERSEAL 4 POSITIONS
 THERMAL DRILL CONNECTOR TYPE AMP SUPERSEAL 2 POSITIONS

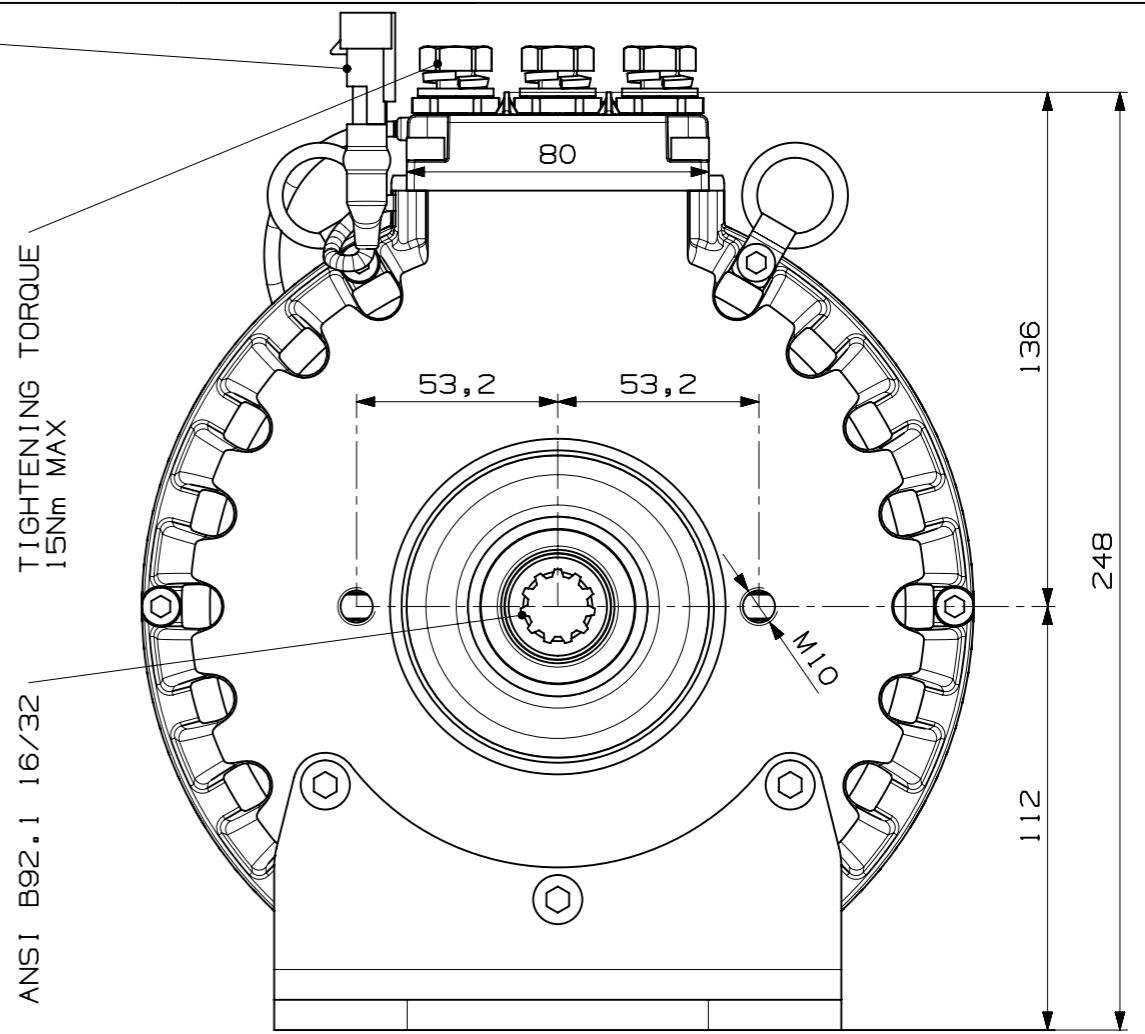

TIGHTENING TORQUE
 15Nm MAX
 ANSI B92.1 16/32

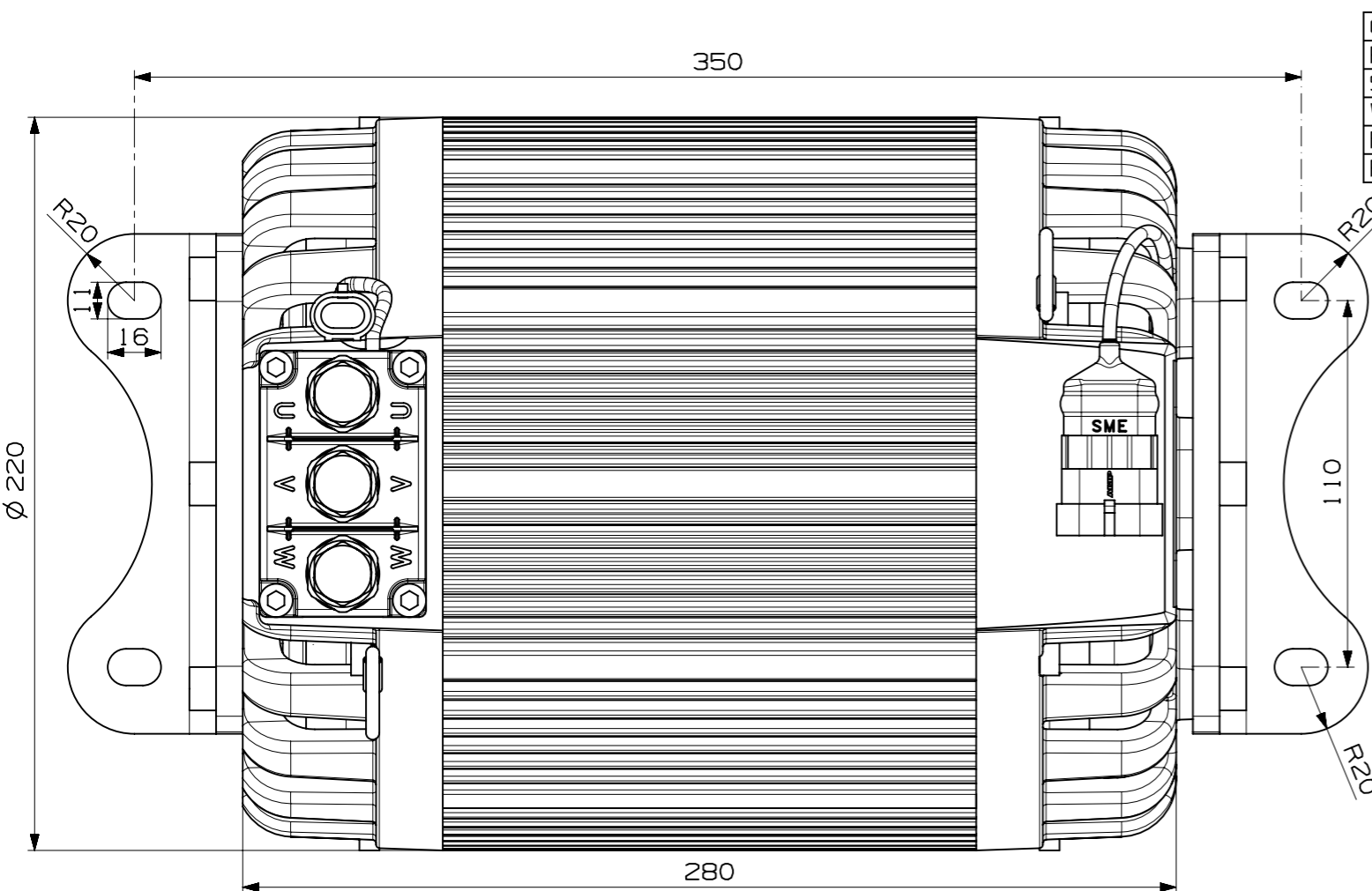

COMPONENT	CODE
ROTOR	MT373B
STATOR	MT580B
WINDING	MT377B
FRONT COVER	MT605B
REAR COVER	MT592B

MAGNETIC SENSOR	
PIN 1	POSITIVE
PIN 2	GROUND
PIN 3	CHANNEL A
PIN 4	CHANNEL B

RATING DATA ACCORDING TO EN 1175-1 APPENDIX B	
POWER	15 KW
VOLTAGE	32 V
CURRENT	353 A
RATED SPEED	2200 RPM
MAXIMUM SPEED	4500 RPM
FREQUENCY	73 Hz
Cos φ	0,85
SERVICE	S3 15%
INSULATION CLASS	F
PROTECTION DEGREE	IP 20
BEARINGS	6206 2RS
WEIGHT	43,5 Kg

FLAT ROOT SIDE FIT STANDARD : ANSI B92.1 TOLERANCE CLASS 5	
NUMBER OF TEETH	11
PRESSURE ANGLE	30°
NOR DIAMETRAL PITCH	16/32
PITCH DIAMETER	17.463
BASE DIAMETER	15,123
FORM DIAMETER	19.152
MAJOR DIAMETER	19.710
MINOR DIAMETER	16.027
MIN EFF CIRCULAR TOOTH	2.494
MAX ACTUAL CIRCULAR TOOTH	2.560
MAX MEAS BETWEEN PIN	13.317
MEAS PIN DIA	2.743

Rev.	Modification	Date	Signature
5	CHANGED THE BRACKETS	24/10/08	A.C.
4	CHANGED THE SPEED SENSOR	10/05/05	A.C.
3	CHANGED THE STATOR CASE	15/04/05	A.C.
2	MODIFIED FOR UL	02/11/04	A.S.
1	CHANGED DIMENSION Ø82.6 (BEFORE IT WAS Ø83)	09/09/04	A.S.

	Scale:	1:2		MEDIUM LIMIT OF ACCURACY UP TO 6 6 UP TO 30 30 UP TO 120 120 UP TO 315 315 UP TO 1000 1000 UP TO 2000 2000 UP TO 4000 UP TO 10 10 UP TO 50 50 UP TO 120 120 UP TO 400	DRAWN WITH HANDLING ON CAD SYSTEM ONLY	THIS DRAWING IS OUR EXCLUSIVE PROPERTY. IT CAN NOT BE COPIED, REPRODUCED, TRANSMITTED TO OTHER PEOPLE OR USED IN ANY WAY WITHOUT OUR CONSENT. ANY INFRINGEMENT WILL BE LEGALLY PURSUED.										
	DEVIATION	±0,1					±0,2	±0,3	±0,5	±0,8	±1,2	±2	±1°	±0°30'	±0°20'	±0°10'
	TOLERANCE	0,2					0,4	0,6	1	1,6	2,4	4	2°	1°	0°40'	0°20'

	Drawn	A.C.	Replaces	Name	MA150-2148/20 SAE A 11Z
	Approved	A.S.	Replaced	Code	MT325B/5
	Date	09/09/04			Sheet 1 of 2

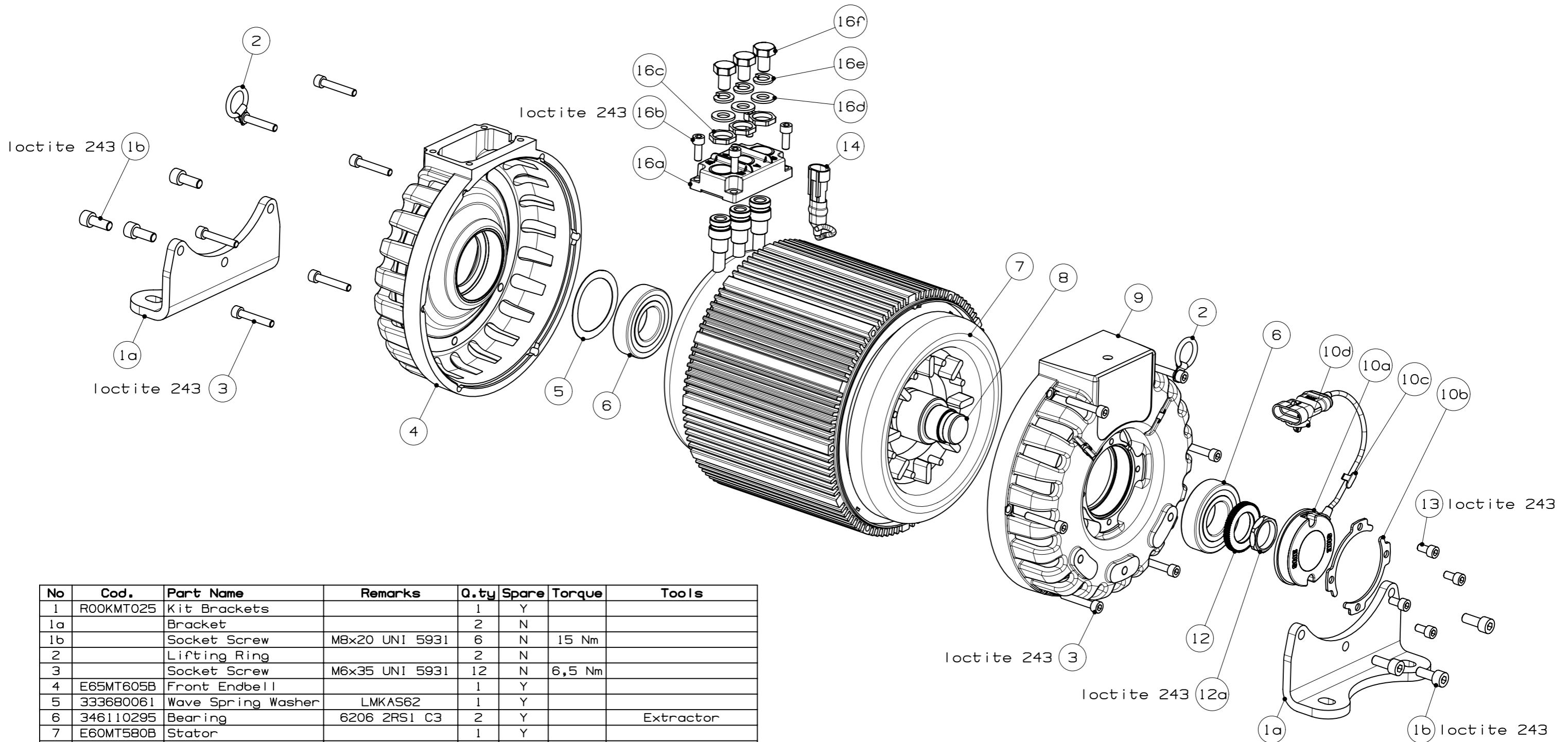

No	Cod.	Part Name	Remarks	Q.ty	Spare	Torque	Tools
1	R00KMT025	Kit Brackets		1	Y		
1a		Bracket		2	N		
1b		Socket Screw	M8x20 UNI 5931	6	N	15 Nm	
2		Lifting Ring		2	N		
3		Socket Screw	M6x35 UNI 5931	12	N	6,5 Nm	
4	E65MT605B	Front Endbell		1	Y		
5	333680061	Wave Spring Washer	LMKAS62	1	Y		
6	346110295	Bearing	6206 2RS1 C3	2	Y		Extractor
7	E60MT580B	Stator		1	Y		
8	E60MT373B	Rotor		1	Y		
9	E65MT592B	Rear Endbell		1	Y		
10	R00KMT028	Kit Speed Sensor		1	Y		
10a		Speed Sensor		1	N		
10b		Locking Flange		2	N		
10c		Fastener		1	N		
10d		Fastener		1	N		
12	E62EC058A	Speed Sensor Gear		1	Y		
12a		Ring Nut		1	N	30 Nm	Pneumatic Screwer
13		Socket Screw	M6x12 UNI 5931	4	N	6,5 Nm	
14	E96CMT386A	Thermal Drill		1	Y		
16	R00KMT024	Kit Terminal Board		1	Y		
16a		Terminal Board		1	N		
16b		Socket Screw	M6x16 UNI 5931	4	N	4 Nm	
16c		Ring Nut	M18x1,5	3	N	17 Nm	Special Wrench
16d		Washer	∅ 10 UNI 6592	3	N		
16e		Spring Washer	∅ 10 UNI 1751	3	N		
16f		Hexagonal Screw	M10x16 UNI 5739	3	N	15 Nm	

Rev.	Modification	Date	Signature
5	CHANGED THE BRACKETS	24/10/08	A.C.
4	CHANGED THE SPEED SENSOR	10/05/05	A.C.
3	CHANGED THE STATOR CASE	15/04/05	A.C.
2	MODIFIED FOR UL	02/11/04	A.S.
1	CHANGED DIMENSION ∅82.6 (BEFORE IT WAS ∅83)	09/09/04	A.S.

	Scale:	MEDIUM LIMIT OF ACCURACY	UP TO 6	BESIDES 6 UP TO 30	BESIDES 30 UP TO 120	BESIDES 120 UP TO 315	BESIDES 315 UP TO 1000	BESIDES 1000 UP TO 2000	BESIDES 2000 UP TO 4000	UP TO 10	REFERENCE	MINOR ANGLE	SIDE		THIS DRAWING IS OUR EXCLUSIVE PROPERTY. IT CAN NOT BE COPIED, REPRODUCED, TRANSMITTED TO OTHER PEOPLE OR USED IN ANY WAY WITHOUT OUR CONSENT. ANY INFRINGEMENT WILL BE LEGALLY PURSUED.
	1:2	DEVIATION	±0,1	±0,2	±0,3	±0,5	±0,8	±1,2	±2	±1*	±0°30'	±0°20'	±0°10'		
		TOLERANCE	0,2	0,4	0,6	1	1,6	2,4	4	2*	1*	0°40'	0°20'		

	Drawn	A.C.	Replaces	Name	MA150-2148/20 SAE A 11Z
	Approved	A.S.	Replaced	Code	MT325B/5
	Date	09/09/04			Sheet